



VistaPark

WONGAWILLI



Master Plan



Bankbook Park

Bankbook Park is a park like no other in the region. It is set in an attractive natural setting by the banks of the creek which flows from the escarpment to the coastal plain right through the heart of Vista Park. With a design heavily influenced by its surroundings, Bankbook Park, features natural play areas scattered along an exploration trail just waiting to be discovered, a state of the art playground and barbecues and shaded picnic tables.

The playground features restored mining artefacts from the local Wongawilli Coal Mine placed on display as play equipment and sculptures.

Some of Bankbook Park's unique features include:

- Rail man cars which were used to shuttle the miners from the shaft entrance to the pit for daily work – now restored and made safe for children to climb through.



- Transmission towers that used to supply power to the mine – now used as part of the flying fox structure.
- An enormous steel boiler which was the heart of the mines operation, and much more.

A network of cycleways connect Bankbook Park to the community providing opportunities for walking, running and cycling.

Smiths Ln Dairy Café

Set in the historical and heritage-listed dairy shed at Coral Vale Homestead, Smiths Ln Dairy is truly a unique project. The Dairy combines an eatery using locally roasted coffee, general store stocking local products, and a discovery garden for kids to let their imagination run wild while you enjoy the picturesque view.

Smiths Ln Dairy supports the community by using local supplies and sustainable practices.



Little Zak's Academy Child Care Centre

Little Zak's Academy Wongawilli is a state of the art childcare centre developed by Sheargold. The unique architecture is inspired by the Qanset barn that used to sit near the dairy sheds. The Academy features a one-of-a-kind playground custom built to reflect the heritage of Vista Park and inspire the youngest members of the community. The Academy was designed to meet Little Zak's aim of providing excellence in early childhood care and education in a safe, welcoming, adopting and nurturing environment.



High-Speed Broadband

State of the art telecommunications will be at the fingertips of Vista Park residents with optical fibre network being provided to all homes. The many benefits of ultra fast broadband include a work life balance by facilitating the option to work from home, keeping in touch with those who matter most as well as providing access to streaming for various forms of entertainment.



Master Plan

TheRidge

The Best of Coast and Country Living

Perhaps the most exclusive offering at Vista Park, 'The Ridge' will comprise only 70 home sites with scenic views of the escarpment and surrounds.

TheGrove

Wander in the Parklands

'The Grove' features a traditional neighbourhood design with over 120 home sites that boast direct access to large manicured parklands bordered by a fully regenerated creek.

TheVale

Be captivated by Heritage

Deriving its name from the original farm holding known as Coral Vale Homestead, 'The Vale' has 230 home sites embracing the original and fully restored homestead.

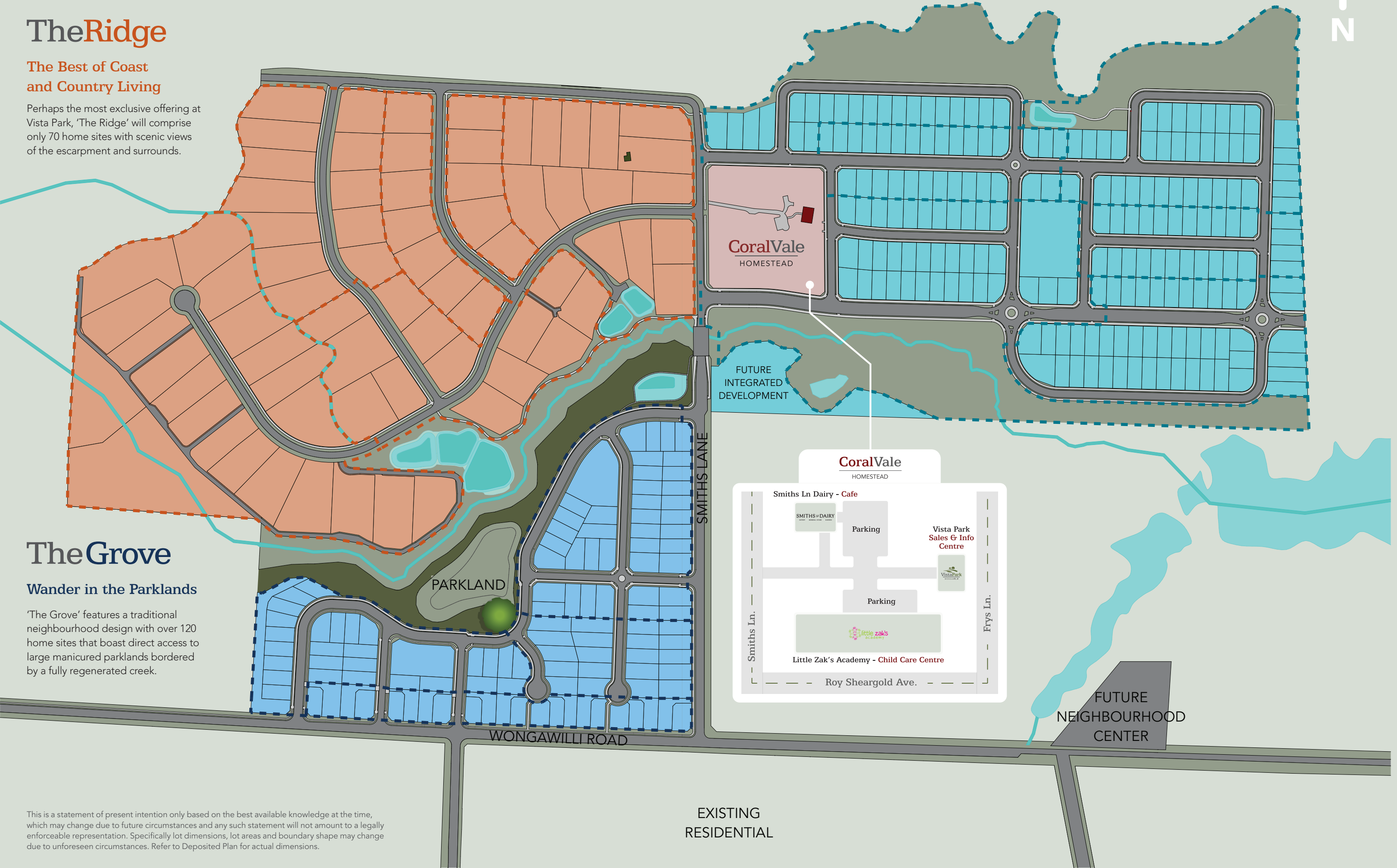

This is a statement of present intention only based on the best available knowledge at the time, which may change due to future circumstances and any such statement will not amount to a legally enforceable representation. Specifically lot dimensions, lot areas and boundary shape may change due to unforeseen circumstances. Refer to Deposited Plan for actual dimensions.

History & Heritage

In order to create a community with its own authentic and unique identity, even for the very first residents, local history and heritage has been encapsulated throughout the Vista Park Master Plan.

Aboriginal Heritage

The original Aboriginal inhabitants and traditional owners of the land on which Vista Park now sits are the Dharawal people. As there was no permanent water supply they most likely used the area for short term camping and foraging.



Aboriginal artefacts found during archeological investigations.

Coral Vale History

European settlers first came to the Wongawilli region in the early 1800s when a small land grant was made to William Fry in 1831. The Rose family purchased the land from William Fry in 1862 and built the current homestead around 1890.



Coral Vale Homestead before restoration.

Wongawilli History

Throughout its history Wongawilli has had two main industries being the dairy industry and coal mining. Coal was first discovered in the Wongawilli region around the 1880s, however, the first coal mining activity didn't take place until 1906.



An old rail car used to transport workers to the Wongawilli Mine.

Heritage at Vista Park

Just some of the ways you will see this heritage reflected throughout Vista Park are:

- Coral Vale Homestead's restoration to become the Vista Park Sales and Information Centre
- The traditional Australian Colonial design encouraged in the rural setting of The Ridge
- A heritage and discovery trail throughout Bankbook Park



Restored Coral Vale Homestead.



Live the Life.

Sheargold
inspiring spaces